

TOSHIBA OWNER MANUAL

Toshiba Home AC Control

Please visit the application store on your device to download and install Toshiba Home AC Control application.



Application

Keyword : Toshiba Home AC Control

Toshiba Home AC Control application support.



iOS : 9.0 or later.



Android : Version 5.0 or later.

About Toshiba Home AC Control.

1. Toshiba Home AC Control can control A/C operation by Smartphone or tablet (mobile device) via internet connection.
2. Everywhere control, control software run on Cloud system and mobile device can set and monitor A/C operation via internet connection.
3. Customer can control, 1 adapter maximum 5 Users (use 1 email to register).
4. Multi A/C system control, 1 user can control 10 A/C.
5. Group control.
 - 5.1 Customer can create and control 3 groups of A/C.
 - 5.2 Customer can control max 10 A/C per group.

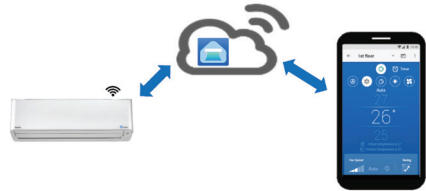

Note :

1. Adapter can register only 1 email address, if register with new email, current email will be invalid.
2. 1 email address can be used with register for 5 mobile devices for control same A/C.

Registration process.

Open an application and follow register for User registration.

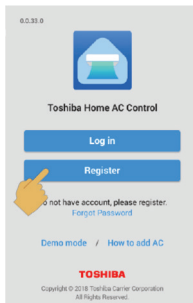

① Tab Register

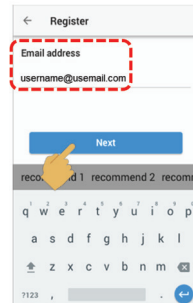

② Enter email address

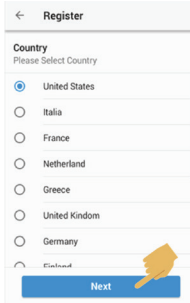

③ Select country

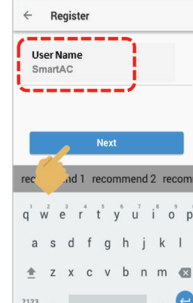

④ Enter user name

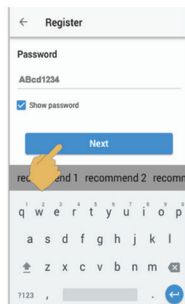

⑤ Enter password by 6-10 characters, combination of alphabet and number

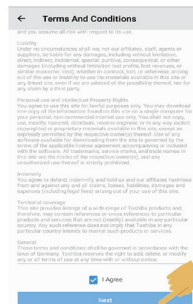

⑥ Check for terms and conditions

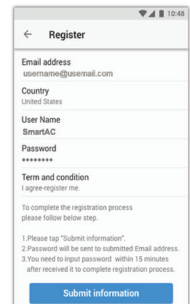

⑦ Confirm information



⑧ Information will be submitted to email, click link to confirm

Login to Toshiba Home AC Control application.

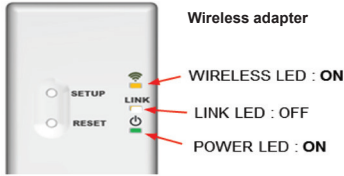

*Note

1. In case of Wi-Fi router change or Email for register change need to re-process for add Wireless adapter again (need to press SETUP button 1 time for active AP mode).
2. In case of change Wireless adapter to use with other A/C need to factory reset (press and hold SETUP 5s) and re-process for add Wireless adapter again.

① Connect Wireless adapter to A/C and turn on power supply.

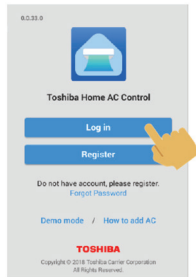

② Open application and select Log in.

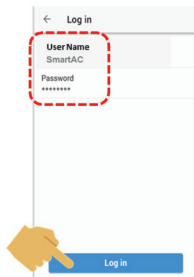

③ Enter user name and password.



④ Login successful.

Add Wireless adapter for control by Toshiba Home AC Control application.

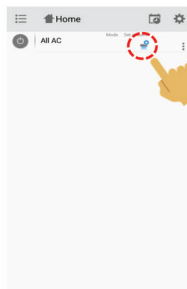

① Select "Add AC (Adapter)" from both display above.

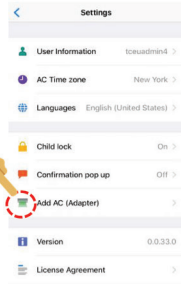

② Select the way for add AC above.



③ SSID and Password input



④ Connect with Home Wi-Fi Router

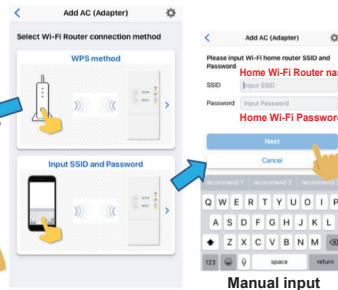

Manual input

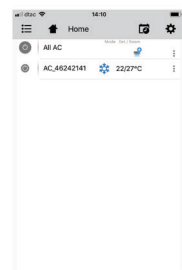

⑤ A/C add finished

Toshiba Home AC Control application.
Home screen

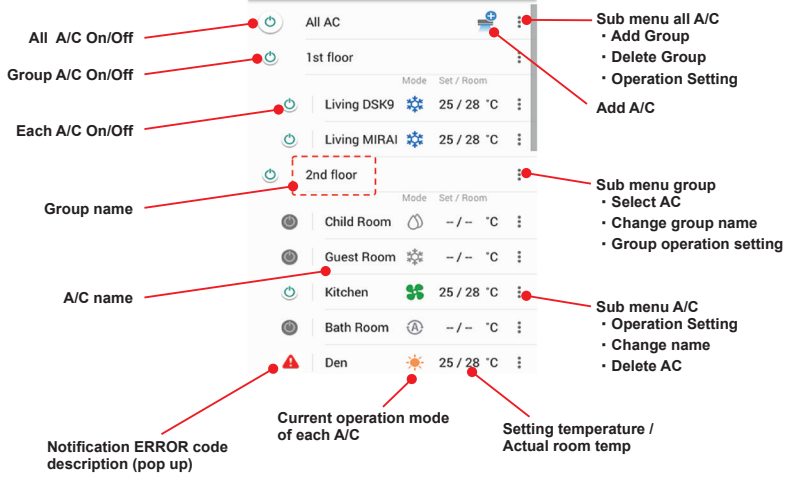
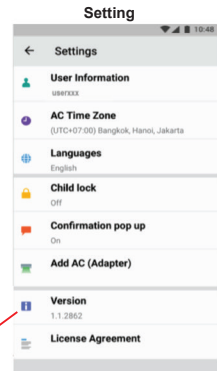
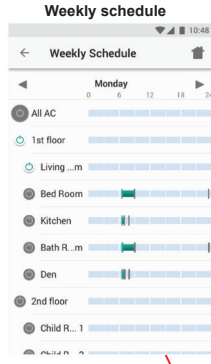
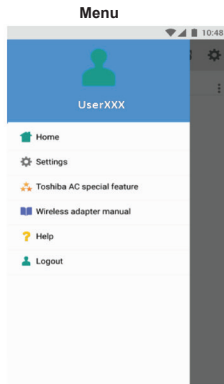
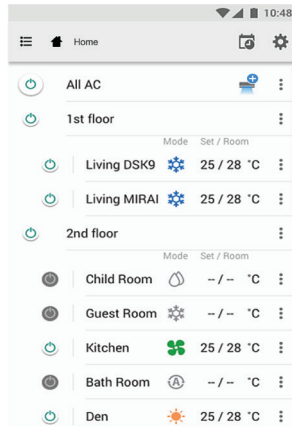

Mode and Condition setting.

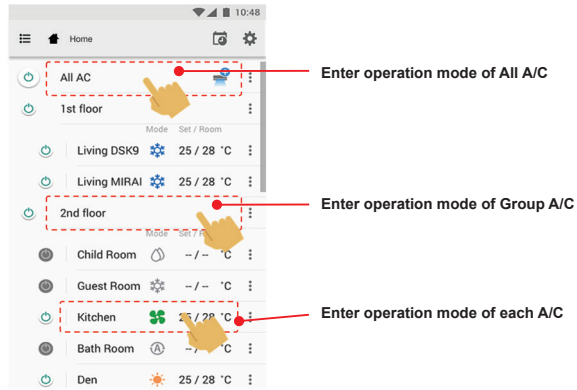

Mode select for Toshiba Home AC Control application.

Provide for 5 operation modes



Setting in operation mode.

Mode select

Tab for select A/C

Weekly schedule

OFF-ON Timer set

Temperature set

Indoor temperature

Outdoor temperature

Off mode

OFF-ON timer set 0.5-12hrs.

Off Timer
Please Select hour

- 0.5
- 1.0
- 1.5
- 2.0
- 2.5
- 3.0
- 9.6

On Timer
Please Select hour

- 0.5
- 1.0
- 1.5
- 2.0
- 2.5
- 3.0
- 9.6

ON timer set from Off mode only

Fan speed and louver set

Special feature

Off mode

LED wireless adapter and A/C ON/OFF control.

Room name

Wireless adapter

Adapter version
1.00.02

LED Wireless adapter
LED AC + Adapter

Select On/Off

SETUP LINK

RESET

Group operation.

Maximum 3 groups

1 Group maximum = 10 units.

Add group

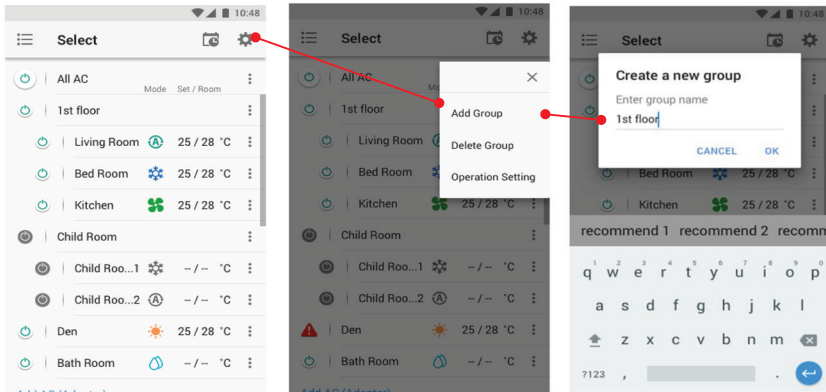

Add A/C in group

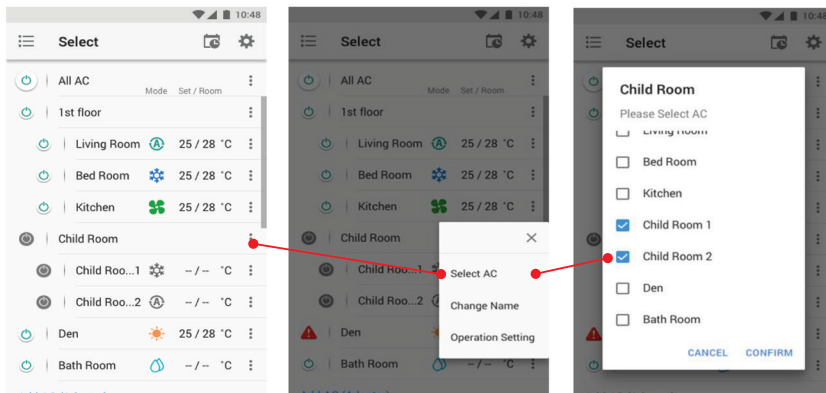

Delete A/C in group

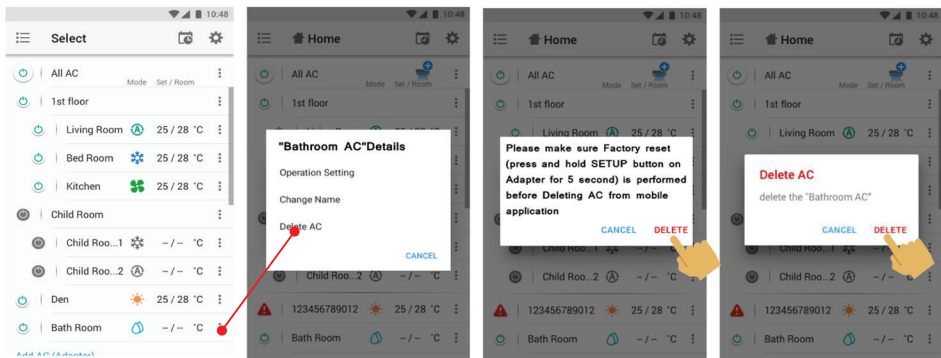

Weekly schedule set.

Day select
Monday - Sunday

Weekly schedule of all A/C unit

Weekly schedule of all A/C unit

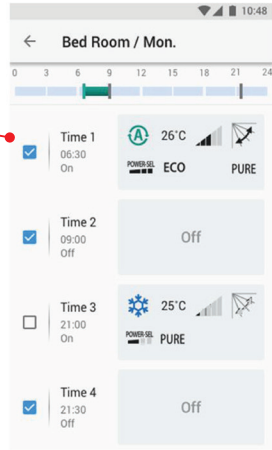
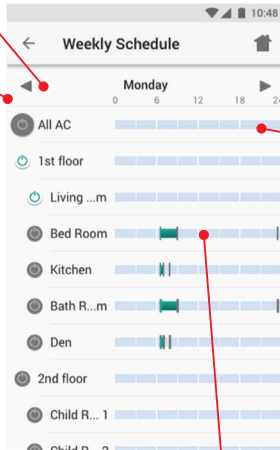
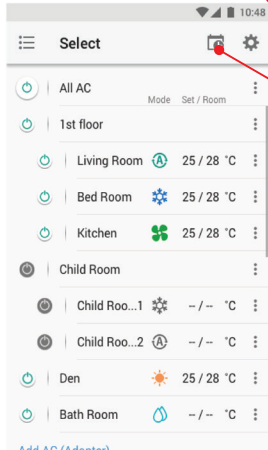

Weekly schedule set for each unit

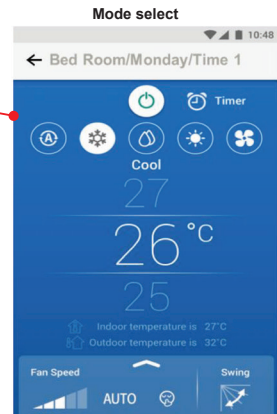
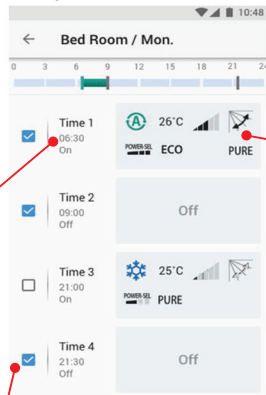
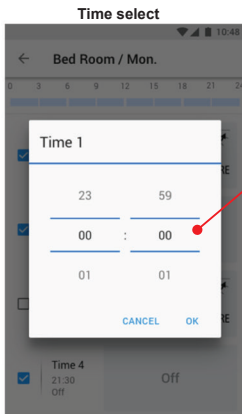

Select program for active by tick at select box

Weekly schedule cancel.

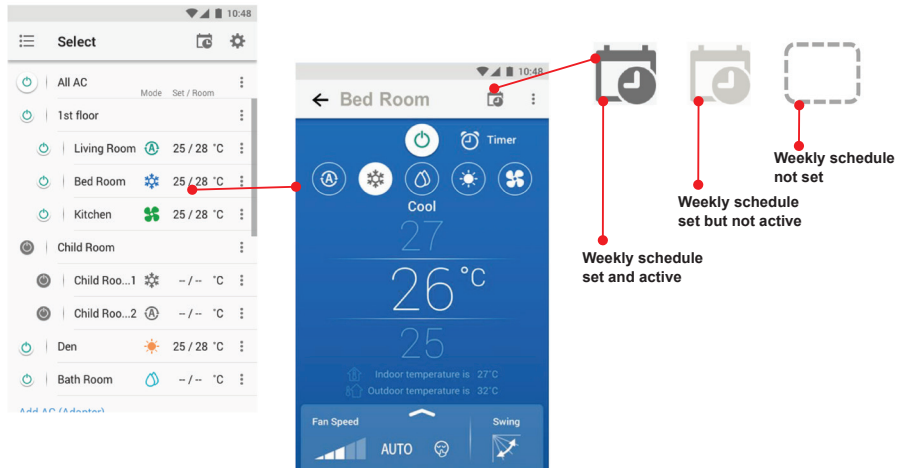

Note :

“The Wireless Adapter must be installed, maintained, repaired and removed by a qualified installer or qualified service person.”

“De Draadloze adapter moet worden geïnstalleerd, onderhouden, gerepareerd en verwijderd door een vakbekwame installateur of een vakbekwame servicemonteur.”

«Η εγκατάσταση, συντήρηση, επισκευή και αφαίρεση του Ασύρματου προσαρμογέα πρέπει να γίνεται από καταρτισμένο τεχνικό εγκατάστασης ή καταρτισμένο τεχνικό σέρβις.»

“L’adattatore wireless deve essere installato, sottoposto a manutenzione, riparato e rimosso da un installatore qualificato o da personale di assistenza qualificato.”

“El adaptador inalámbrico debe ser instalado, mantenido, reparado y retirado por un instalador cualificado o una persona de manenimiento cualificada.”

“Langattomansovittimenasennus, huolto, korjausjapoistoonannettava pätevän asentajan tai huoltohenkilön tehtäväksi.”

“Trådløs-adapteren må installeres, vedlikeholdes, repareres og fjernes av en kvalifisert installatør eller kvalifisert servicetekniker.”

“Der kabellose Adapter muss von einem qualifizierten Installateur oder einem qualifizierten Dienstleister installiert, gewartet, repariert oder ausgebaut werden.”

« L'interface sans fil doit être installée, entretenue, réparée et retirée par un installateur qualifié ou un technicien qualifié. »

„Bezdrátový adaptér musí instalovat, udržovat, opravovat a odstraňovat kvalifikovaný technik nebo kvalifikovaný servisní pracovník.“

« L'adaptateur sans fil doit être installé, entretenu, réparé et retiré par un installateur qualifié ou un technicien qualifié. »

„A vezeték nélküli adapter felszerelését, karbantartását, javítását és leszerelését szakképzett klímaszerelőnek vagy szakképzett karbantartási szakembernek kell végeznie.“

“Brezžični adapter mora namestiti, vzdrževati, popravljati ali odstraniti usposobljeni inštalater ali usposobljeni serviser.”

„Bezdrôtový adaptér je oprávnený nainštalovať, udržiavať, opravovať a odstraňovať len kvalifikovaný technik alebo vvkvalifikovaný servisný pracovník.“

“ต้องให้ช่างติดตั้งที่มีความชำนาญหรือผู้ให้บริการที่มีความชำนาญเป็นผู้ติดตั้ง บำรุงรักษา ซ่อมแซม และถอดอุปกรณ์รับส่งสัญญาณไร้สาย”

“Kablosuz bağıdaştırıcı, uzman bir tesisatçı ya da yetkili servis personeli tarafından kurulmalı, bakımı yapılmalı, onarılmalı ya da sökülmelidir.”

“무선 어댑터는 자격이 있는 설치 기사나 서비스 담당자가 설치, 유지 보수, 수리, 제거해야 합니다.”

“Bộ chuyển đổi không dây phải được lắp đặt, bảo dưỡng, sửa chữa và tháo dỡ bởi người có trình độ hoặc người có chuyên môn.”

「無線介面卡必須由合格的安裝人員或合格的維修人員進行安裝、維護、維修和移除。」

“Contact dealer and/or service center when equipment is malfunction.”

“Neem contact op met de dealer en/of het servicecentrum wanneer de apparatuur niet goed werkt.”

«Επικοινωνήστε με τον αντιπρόσωπο ή/και το κέντρο σέρβις σε περίπτωση δυσλειτουργίας του εξοπλισμού.»

“Contattare il rivenditore e/o il centro di assistenza quando l'apparecchiatura non funziona correttamente.”

“Póngase en contacto con el distribuidor y/o el centro de servicio cuando el equipo no funciona bien”.

“Jos laitteessa ilmenee vikaa, ota yhteyttä jälleenmyyjään ja/tai huoltoliikkeeseen.”

“Kontakt forhandler og/eller servicesenter når det oppstår feil på utstyret.”

“Wenden Sie sich an den Händler und/oder das Servicezentrum, wenn das Gerät nicht funktioniert.”

« En cas de dysfonctionnement de l'équipement, veuillez contacter le revendeur et/ou le centre de service. »

„Kontaktujte prodejce a/nebo servisní středisko v případě poruchy zařízení.“

“U slučaju kvara na uređaju obratite se distributeru ili servisnom centru.”

„A készülék hibás működése esetén forduljon a kereskedőhöz és/vagy a szervizközpontoz.”

“V primeru okvare kontaktirajte dobavitelja in/ali servisni center.”

„Ak je zariadenie nefunkčné, obráťte sa na predajcu a/alebo servisné stredisko.“

“โปรดติดต่อผู้แทนจำหน่ายและ/หรือศูนย์บริการหากอุปกรณ์ทำงานผิดปกติ”

“Donanim arızalanırsa, satıcı ve/veya servis merkezi ile iletişime geçin.”

“장비가 고장난 경우 대리점 및 / 또는 서비스 센터에 문의하십시오.”

“Liên hệ đại lý bán hàng và/hoặc trung tâm dịch vụ khi thiết bị gặp trục trặc.”

「設備發生故障時，請聯絡經銷商及/或服務中心。」

